



Innovative safety and service bracket for quick separation of valve and actuator

MSB

MODU Safety and Service Bracket

- Stainless steel CF8M/AISI316. F03/04, F05/F07, F07/F10
- Innovative compact safety and service bracket for quick separation of valve and actuator. Available in 3 sizes up to F10, which can be freely combined. The bracket is equipped with blowout/exhaust holes.
- Compact and robust construction made of acid-proof stainless steel
- ISO5211 connection
- Easy assembly due to the 2-piece design
- The service clamp fits all 3 bracket sizes
- Easy to clean
- 100% non-backlash connection due to the conical clamp assembly

Make it better.



MSB

MODU Safety and Service Bracket • PATENT EP17182968

Application

For mounting actuator onto valve, where fast separation/service is needed.

Connection ISO-5211

MSB-F34 / MSB-F34-EXT: F03/F04
 MSB-F57 / MSB-F57-EXT: F05/F07
 MSB-F71: F07/F10

Spare parts

- Complete clamp-kit
- Complete bracket
- Upper, or lower bracket part

Accessories

- Coupling, stainless steel
- Precision coupling for control valve
- LOCKOUT/TAGOUT locking pad



Possibility of locking with a padlock

The MSB-II is equipped with locking eye, which can be used for LOCK-OUT or unintended use.

Developed for your industry



Additional specification can be requested.

Make it better.

MODU Valves A/S • moduvalves.com

Description of parts

Pos	Description	Pcs	Material
1	Bracket upper part.....	2	Stainless steel CF8M (AISI316)
2	Bracket lower part	2	Stainless steel CF8M
3	Threaded hinge pin...1		Stainless steel AISI316
4	Clamp handle.....	1	Stainless steel CF8M
5	Threaded bushing.....	1	Stainless steel AISI316
6	Threaded pull rod	2	Stainless steel AISI316
7	Threaded bushing.....	2	Stainless steel AISI316

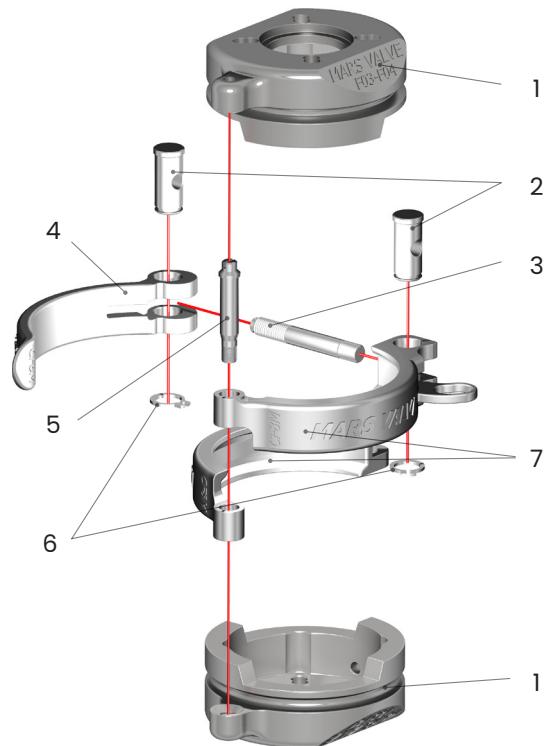

➤ Improve the quality

We help Engineers to improve the quality of your manufacturing process.

➤ Optimize total cost

We help Purchasing Officers to optimize total cost of production, prevent downtime and safeguard your brand.

➤ Work smarter

We help Maintenance Crews to work smarter, while preventing time-consuming mistakes.

MSB

MODU Safety and Service Bracket • PATENT EP17182968

Dimensions

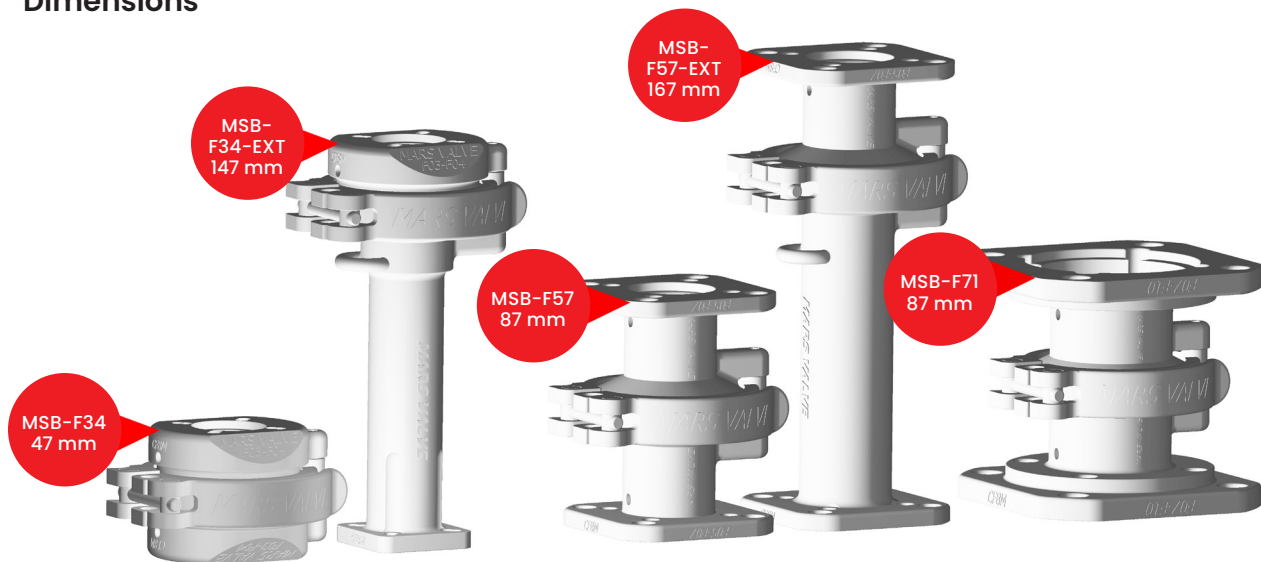

Lower bracket		Upper bracket	Total height	Info
MSB-F34 (F03-F04)	+	MSB-F34 (F03-F04)	47 mm	Standard bracket
MSB-F34-EXT (F03-F04)	+	MSB-F34 (F03-F04)	147 mm	Extended bracket for up to 100mm insulation
MSB-F57 (F05-F07)	+	MSB-F57 (F05-F07)	87 mm	Standard bracket
MSB-F57-EXT (F05-F07)	+	MSB-F57 (F03-F04)	167 mm	Extended bracket for up to 100mm insulation
MSB-F71 (F07-F10)	+	MSB-F71 (F07-F10)	87 mm	Standard bracket
MSB-F71 (F07-F10)	+	MSB-F57 (F03-F04)	87 mm	Standard bracket
MSB-F34 (F03-F04)	+	MSB-F57 (F05-F07) MSB-F71 (F07-F10)	67 mm	Special coupling required, contact MODU Valves
MSB-F34-EXT (F03-F04)	+	MSB-F34-EXT (F03-F04)	247 mm	Special coupling required, contact MODU Valves
MSB-F57-EXT (F05-F07)	+	MSB-F57-EXT (F05-F07)	247 mm	Special coupling required, contact MODU Valves

MSB

MODU Safety and Service Bracket • PATENT PENING EPI7182968

Combining the Mars Service Bracket

MSB-F34 to MSB-F71 service bracket can be freely assembled as they use the same clamp spanning. However, not all combination options are available with standard couplings. Ask MODU Valves for advice in case of special combination options are requested.

Correct usage of the MODU Service Bracket

The MSB series Service brackets works by mounting the bracket parts to valve part and actuator. The assembly of upper and lower bracket parts takes place from the supplied clamp ring and handle. The clamp consists of 2 half symmetric parts, and a threaded hinge pin through. The supplied hinge pin has to be fixed to the part of the bracket that is located on the valve top. This ensures that the clamp is retained even when the bracket is separated and the actuator is removed. The clamp ring can be removed at any time if required.

IMPORTANT! Adjusting of the clamp

When closing the clamp for the first time around the bracket, it is important that the handle is tightened properly. The handle must not be loose when it is closed against the bracket. The tightness can easily be adjusted by rotating the clamp handle 360 ° (clockwise). If the tightness is insufficient, make a new rotation until the clamp locks firmly against the bracket. The handle is self-locking on the last part of the closure and does not get loose during operation of the valve, regardless of the orientation of the assembly.

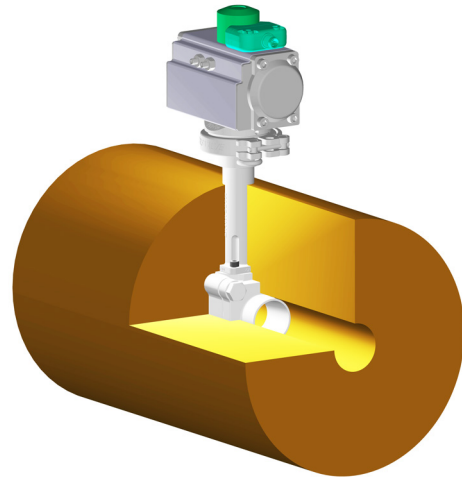

MSB-F34-EXT with 1" ball valve and 100 mm insulation

