



Built-in stop
for 0 and 90°

X

Stem extension for MODU 83/55 ball valve DN08-50

- Stainless steel CF8 / AISI304
- For 50mm or 100mm insulation
- Simple reliable stem extension fully casted in stainless steel for MODU 83 and 55, 3-pcs ball valves
- Available in 50mm and 100mm height.
- Built-in stop for 0 and 90°

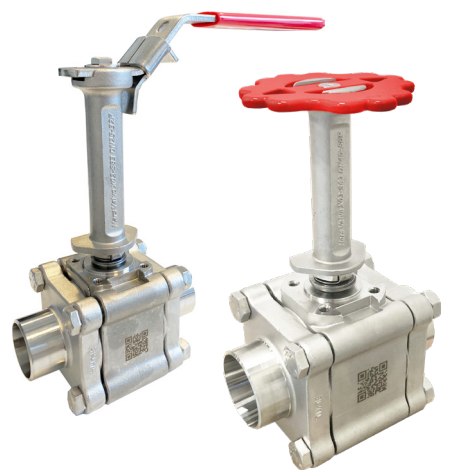

Make it better.

MODU®

X

Stem extension for MODU 83/55 ball valve DN08-50

Field of application

For insulating purpose of hand operated ball valves.

Dimensions

- X01a (50mm): MODU 83 DN08-20F DD6.5
- X01 (100mm): MODU 83 DN08-20F DD6.5
- X02a (50mm): MODU 83 DN25-32F DD8.0
- X02 (100mm): MODU 83 DN25-32F DD8.0
- X03a (50mm): MODU 83 DN40-50F DD9.7
- X03 (100mm): MODU 83 DN40-50F DD9.7

Accessories

- Safety handle Ø95mm DN08-50F (fits all stem extensions). Prevents unintended operation of the ball valve. Safety handle are made from stainless steel with epoxy coating. Safety handle can be operated without T-bar handle up to DN20F.
- T-bar handle in stainless for size DN25-DN50



Parts description, excerpt

Pos	Description	Material
1	Stem extension	Stainless steel CF8
2	Washer	Stainless steel A2
3	Bolt	Stainless steel A2
4	Socket screw	Stainless steel A2

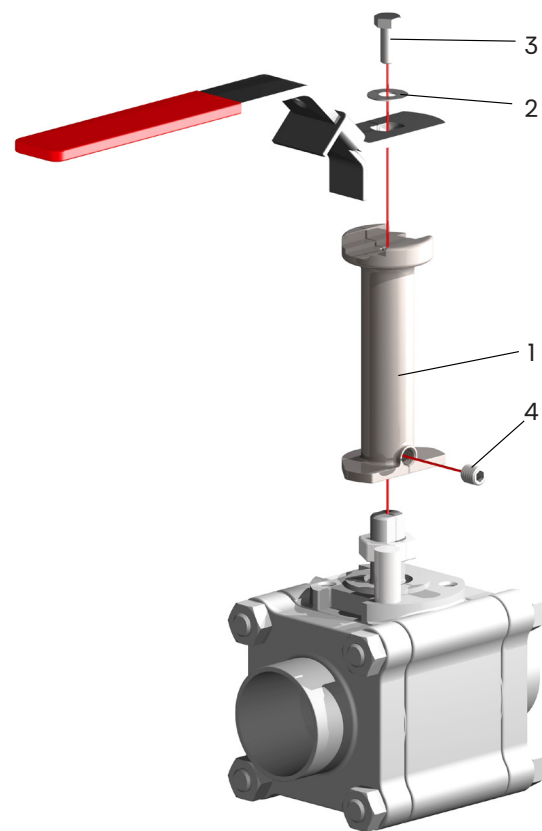

Developed for your industry



Additional specification can be requested.

Make it better.

MODU Valves A/S • moduvalves.com

➤ Improve the quality

We help Engineers to improve the quality of your manufacturing process.

➤ Optimize total cost

We help Purchasing Officers to optimize total cost of production, prevent downtime and safeguard your brand.

➤ Work smarter

We help Maintenance Crews to work smarter, while preventing time-consuming mistakes.

X

Stem extension for MODU 83/55 ball valve DN08-50

Dimensions

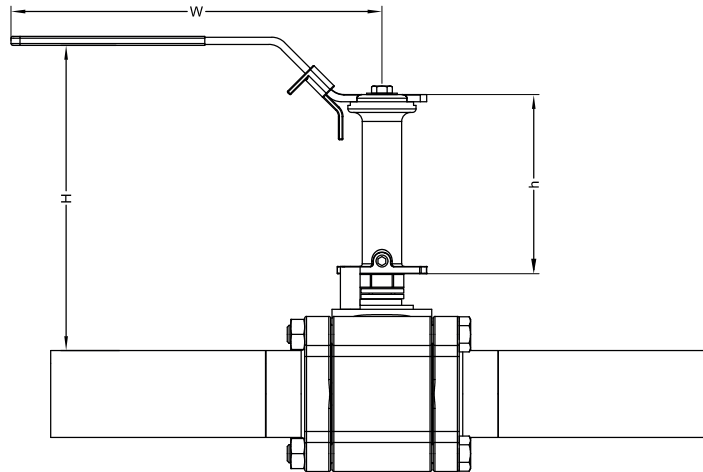

Dimension MODU 83/55 FB*	h (50mm extension)		h (100mm extension)		W	MODU 83/55* Full bore butt weld			MODU 83 Reduce bore butt weld		
	Dim	H (50mm)	Dim	H (100mm)		Dim	H (50mm)	H(100mm)	Dim	H (50mm)	H(100mm)
08 (1/4")	50mm	X01a	100mm	X01	134	08 (1/4")	101,7	151,7	-	-	-
10 (3/8")	50mm	X01a	100mm	X01	134	10 (3/8")	101,7	151,7	15 (1/2")	99,7	149,7
15 (1/2")	50mm	X01a	100mm	X01	134	15 (1/2")	106,9	156,9	20 (3/4")	104,1	154,1
20 (3/4")	50mm	X01a	100mm	X01	134	20 (3/4")	108,6	158,6	25 (1")	105,2	155,2
25 (1")	50mm	X02a	100mm	X02	170	25 (1")	109,4	159,5	32 (1-1/4")	105,1	155,1
32 (1-1/4")	50mm	X02a	100mm	X02	170	32 (1-1/4")	110,1	160,1	40 (1-1/2")	107,2	157,2
40 (1-1/2")	50mm	X03a	100mm	X03	207	40 (1-1/2")	123,5	173,5	50 (2")	117,5	167,5
50 (2")	50mm	X03a	100mm	X03	207	50 (2")	135,5	185,5	65 (2-1/2")	127,6	177,6

All measurements in [mm] * MODU 55 only FB DN15-50

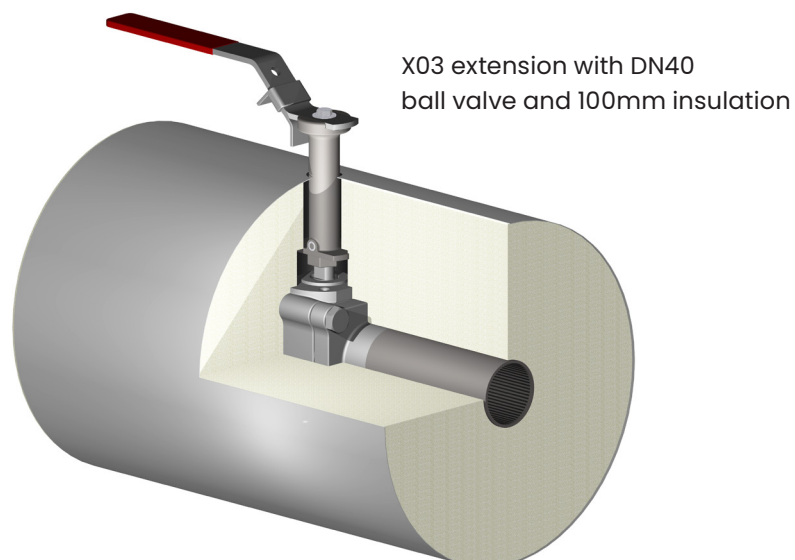

Make it better.

MODU Valves A/S • moduvalves.com

*Not a stock item - available on request (i.e. use a MODU 83 ball valve with CSX)